

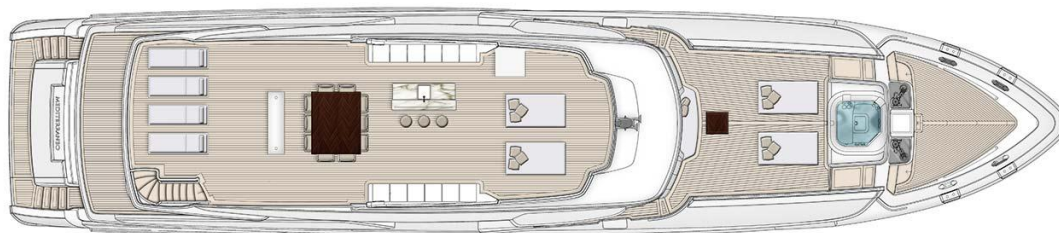

MR. LOUI LTD.  
REPORT "MR. LOUI" VIAREGGIO" JULY 14<sup>TH</sup>, 2017

M/Y "MR. LOUI"

SUN DECK



- CONTINUED WITH POLISH AND REPAIR DETAILS OF PAINT ON SUN DECK, INSTALLING BAR TABLE, BARBECUE TABLE, DOORS AND ACCESORIES.



- WAS INSTALLED LIGHTS, CONNECTED AND TESTED.



- START TO INSTALL ELEVATOR DOOR.



UPPER DECK



MR. LOUI LTD.

M/Y “MR. LOUI”

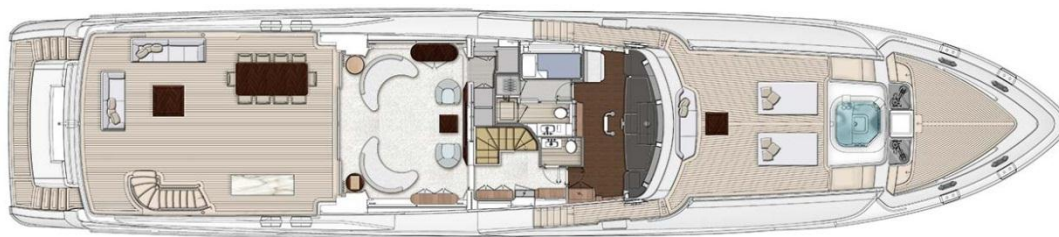

- WAS INSTALLED HANDLE STAIRS FROM UD TO SD.



- CONTINUE WITH CARPENTRY JOBS ON SALON.



- WAS INSTALLING ROOF CELING ON CAPTAIN CABIN.



- START TO INSTALL WOOD FORNITURES OF PILOT HOUSE EQUIPMENT.



MR. LOUI LTD.

M/Y "MR. LOUI"



- WAS MOUNTED ROOF CELING ON AFT DECK.



- WAS INSTALLED LIGHTS AND WAS TESTED.



- BOW TEAK WAS DETAILED.

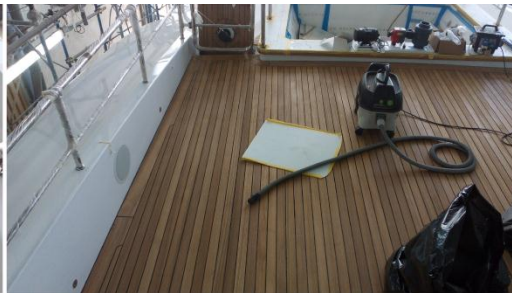
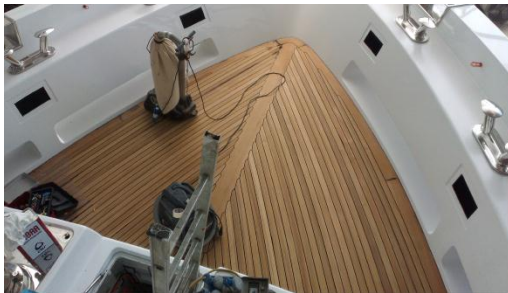



MR. LOUI LTD.

M/Y “MR. LOUI”

MAIN DECK



- CONTINUE TO INSTALL FLOOR, ON MAIN SALON.



- IN THE GALLEY WAS INSTALLED THE MARBLE.



- IN MASTER CABIN, WAS FINISHED TO INSTALL FLOOR.



MR. LOUI LTD.

M/Y "MR. LOUI"



- IN MAIN DECK BATHROOM WAS MOUNTED MARBLE FLOOR.



- WAS MOUNTED ROOF CELING ON AFT DECK.



- WAS INSTALLED LIGHTS AND WAS TESTED.





MR. LOUI LTD.

M/Y "MR. LOUI"

- WAS INSTALLED STAIR HANDRAILS FROM MD TO UD.



LOWER DECK



CREW MESS AND CREW CABINS

- CONTINUE WITH CARPENTRY JOBS.

CREW MESSROOM



ENGINEER CABIN





## MR. LOUI LTD. SB CREW CABIN

M/Y “MR. LOUI”



## PS CREW CABIN



- START TO INSTALL TENDER SUPPORT IN THE GARAGE.



- WAS MOUNTED TEAK ON GARAGE DOOR.



## ENGINE ROOM

- CONTINUE WITH CONNECTION OF WIRES AND CABLES ON ELECTRIC PANELS.



MR. LOUI LTD.

M/Y “MR. LOUI”



- SOUND ALARMS (FIRE, GENERAL , FIRE AND FM200) WAS INSTALLED.



- CONTINUE WITH INSTALLATION OF WATER MAKER.



- WAS SUPPLIED LUB OIL AND COOLANT AT MAIN ENGINES AND LUB OIL AT GEAR BOXES.

